



**LEGEND**

29 LOT NUMBER

(158) HOUSE NUMBER

**BROOKFIELD RESIDENTIAL TREE PLANTING PROGRAM  
- LINE ASSIGNMENT / PUBLIC BOULEVARD TREES ONLY**

- **BROOKFIELD RESIDENTIAL** RESERVES THE RIGHT TO ADJUST ALL PROPOSED TREE PLANTING LOCATIONS TO MEET ALL SETBACK REQUIREMENTS FROM HARD-SURFACES AND UNDERGROUND UTILITY LINES.
- ALL FRONT BOULEVARDS THAT MEET THE MINIMUM GROWING AREA REQUIREMENT SET OUT BY THE CITY OF AIRDRIE SHALL HAVE A PUBLIC LINE ASSIGNMENT TREE IN LIEU OF PRIVATE LOT PLANTING TREE.
- DURING THE DEVELOPER MAINTENANCE PERIOD (APPROXIMATELY 12-24 MONTHS FROM TIME OF PLANTING), THE HOMEOWNER HAS NO OBLIGATIONS TO CARE FOR THE TREE. FOLLOWING THE DEVELOPER MAINTENANCE PERIOD, TREES BECOME CITY PROPERTY AND THE CITY SHALL ASSUME FULL RESPONSIBILITY FOR THE MAINTENANCE & CARE OF THE TREE. ALL LINE ASSIGNMENT / BOULEVARD TREES ARE PROPERTY OF THE DEVELOPER OR CITY AND CAN NOT BE REMOVED OR ALTERED.

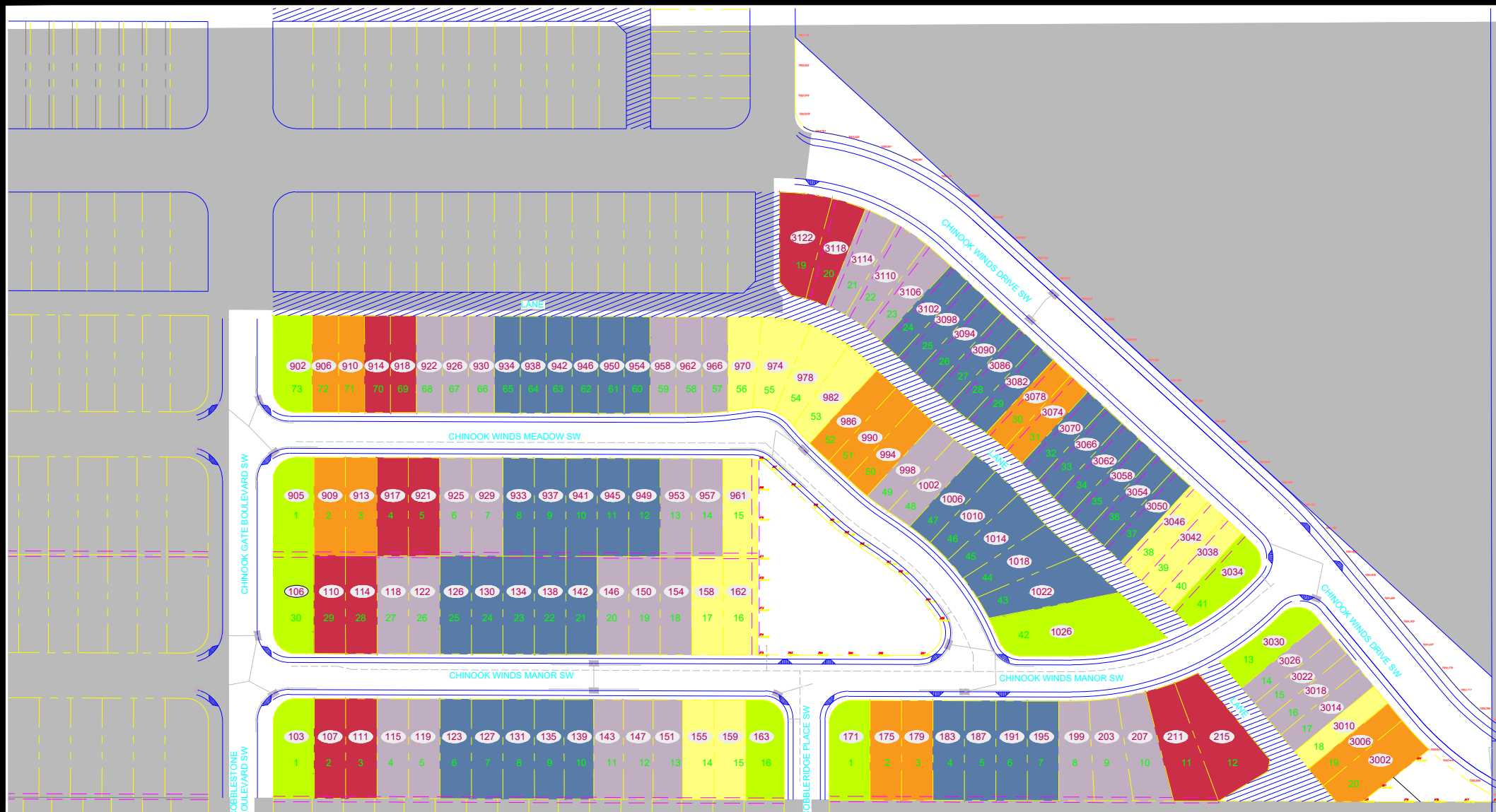

**LEGEND - PRIVATE LOT PLANTING TREES**

<p><b>PATMORE ELM</b> -VASE FORM -HIGH OVERHEAD CANOPY -PLANTED SIZE: 70mm CAL.</p>	<p><b>CORNER LOT MOUNTAIN PINE</b> -ORNAMENTAL UPRIGHT -WINTER EVERGREEN -PLANTED SIZE: 2.5m HT.</p>	<p><b>THUNDERCHILD FLOWERING CRAB</b> -UPRIGHT FORM -PURPLE FOLIAGE -PLANTED SIZE: 75mm CAL.</p>
<p><b>STARLITE FLOWERING CRAB</b> -UPRIGHT FORM -WHITE FLOWERS -PLANTED SIZE: 70mm CAL.</p>	<p><b>PRAIRIE SPIRE GREEN ASH</b> -OVAL FORM -AUTUM GOLD COLOUR -PLANTED SIZE: 70mm CAL.</p>	<p><b>HOT WINGS TATARIAN MAPLE</b> -UPRIGHT FORM -RED ACCENTS -PLANTED SIZE: 75mm CAL.</p>

**BROOKFIELD RESIDENTIAL TREE PLANTING PROGRAM  
- PRIVATE LOT PLANTING TREES ONLY**

- ALL TREES SHOWN ON THE PLANTING LEGEND HAVE BEEN SELECTED BY **BROOKFIELD RESIDENTIAL'S** LANDSCAPE ARCHITECT. THERE WILL BE NO REPLACEMENTS OR SUBSTITUTIONS.
- IF THE HOMEOWNER CHOOSES NOT TO TAKE THE TREES AS SPECIFIED, **BROOKFIELD RESIDENTIAL** WILL NOT PROVIDE OTHER SPECIES AS REPLACEMENT NOR CASH-IN-LIEU FOR TREES.
- ALL TREES TO BE PLANTED AFTER LOT HAS RECEIVED FINAL GRADING & LOAMING.
- **BROOKFIELD RESIDENTIAL** RESERVES THE RIGHT TO ADJUST ALL PROPOSED TREE PLANTING LOCATIONS TO MEET ALL SETBACK REQUIREMENTS FROM HARD-SURFACES AND UNDERGROUND UTILITY LINES.
- **BROOKFIELD RESIDENTIAL** RESERVES THE RIGHT TO MAKE DESIGN MODIFICATIONS TO THE STREETSCAPE PLANTING INCLUDING CHANGES TO TREE LOCATIONS AND SPECIES FROM THAT WHICH IS SHOWN. ALL WILL BE DONE AT THE DISCRETION OF THE LANDSCAPE ARCHITECT.
- IT IS INTENDED THAT ALL TREES SUPPLIED BY **BROOKFIELD RESIDENTIAL** SHALL BE PLANTED IN FRONT YARDS ONLY.
- SHOULD CONFLICTS ARISE BETWEEN UNDERGROUND UTILITIES AND TREE PLANTING, THE TYPES OF TREES PROVIDED & PLANTING LOCATIONS SHALL OCCUR AT THE DISCRETION OF THE LANDSCAPE ARCHITECT.
- TREES PROVIDED & PLANTING SHALL OCCUR AT THE DISCRETION OF THE LANDSCAPE ARCHITECT.
- ALL LOTS WHICH DO NOT HAVE A FRONT BOULEVARD THAT MEETS THE MINIMUM GROWING AREA REQUIREMENT SET OUT BY THE CITY OF AIRDRIE SHALL HAVE A PRIVATE LOT PLANTING TREE.

\* NOTE: TREES ON SITE MAY NOT BE EXACTLY AS SHOWN

TREES:	QTY:
PATMORE ELM	42
MOUNTAIN PINE	9
STARLITE FLOWERING CRAB	13
PRAIRIE SPIRE GREEN ASH	32
THUNDERCHILD FLOWERING CRAB	13
HOT WINGS TATARIAN MAPLE	12



**Chinook Gate Phase 7**  
Residential Streetscape Program

**Brookfield**  
Residential